

Winnebago County, IL
GPS PROJECT 2000

Station Name WIN 20.4N-00.9W A Station No. 77 A

Section 11, Town 28 North, -Range 11 East / West

Town of Shirland, County Winnebago, State Illinois

Observer C. Trueloff; Date of observation 21 Nov. 2000

Order of Control 1ST -Meters -Feet Zone: IL WEST

County Coordinates: N: 641876.212 LAT: 42 26 38.91487 N

H. Datum: NAD 83/91 E: 780349.076 LON: 89 11 23.95638 W

V. Datum: NAVD 88 ELEV: 223.770 ELLIP 190.200 GH '99 -33.57

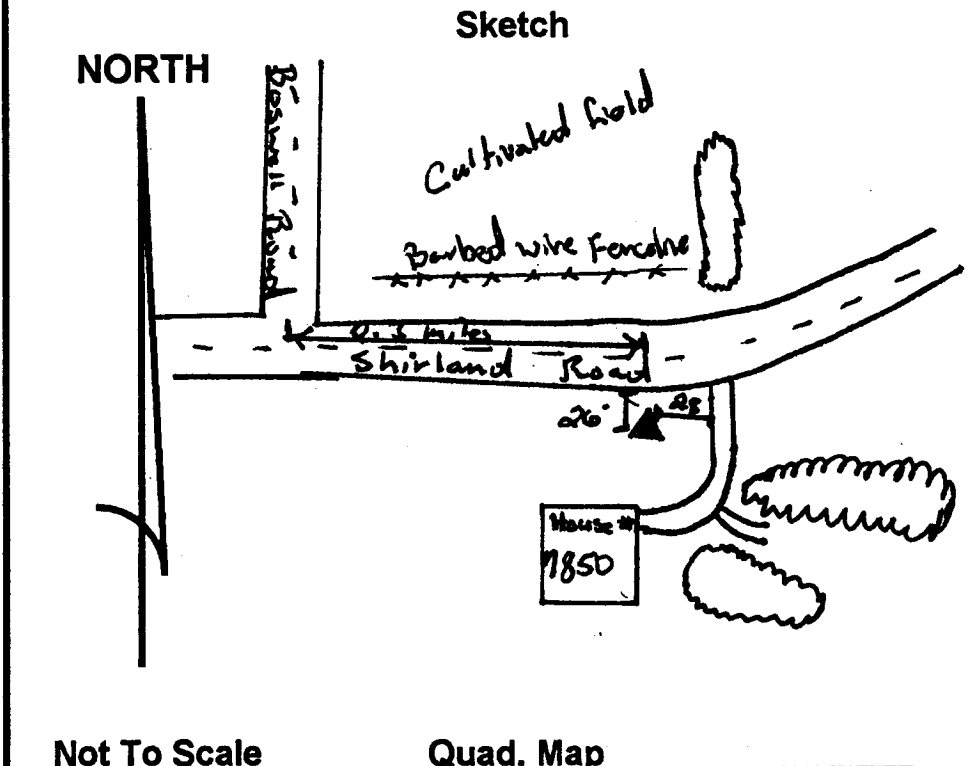
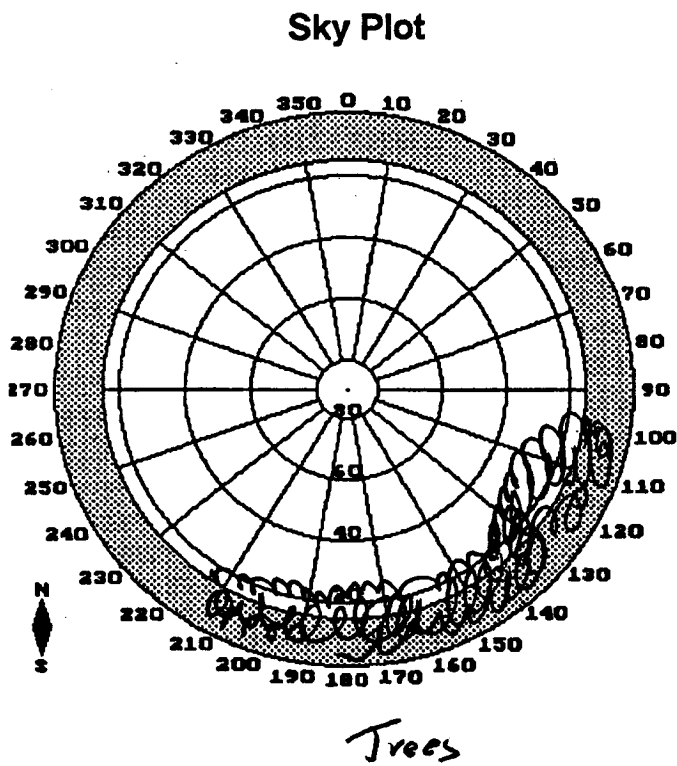
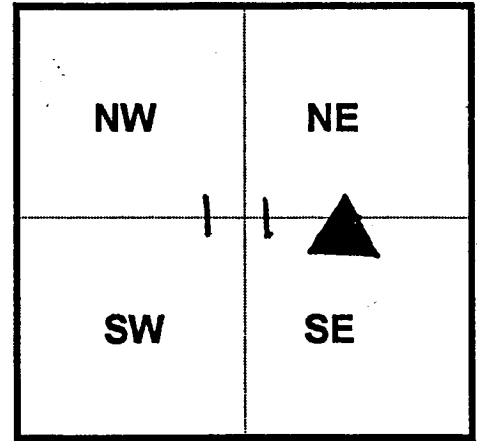

DESCRIPTION: Station is a stainless steel rod in PVC Pipe. Station is 0.3 miles East of Baswell Road, 26 feet South of the South EOP of Shirland Road, 28 feet West of the West EOP of P. E. " 7850 ", and 1 foot North of an orange Carsons witness post.