

Station No. _____

**Winnebago County, IL
GPS PROJECT 2000**

Station Name WIN 10.1N-07.5E Station No. 33

Section 8, Town 44 North, Range 2 East West

Town of Rockford, County Winnebago, State Illinois

Observer ELINDAAS; Date of observation 10/25/00

Order of Control 1ST -Meters -Feet Zone: IL WEST

County Coordinates: N: 625600.307 LAT: 42 17 46.02687 N

H. Datum: NAD 83/91 E: 793896.987 LON: 89 01 40.74928 W

V. Datum: NAVD 88 ELEV: 240.040 ELLIP 206.660 GH '99 -33.38

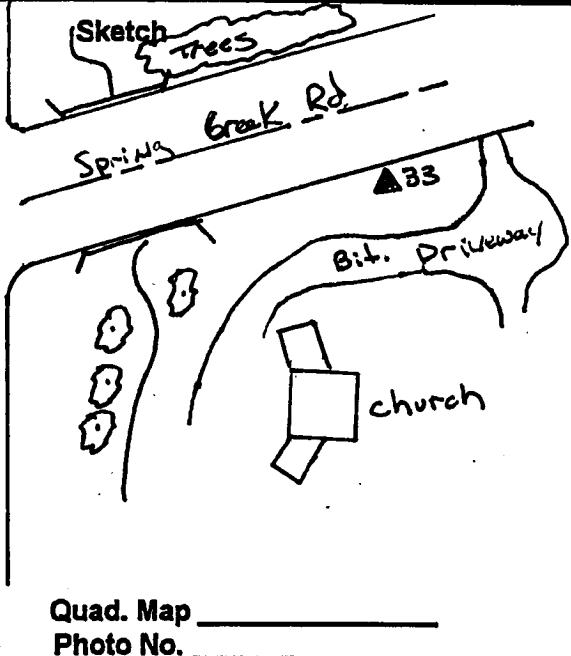
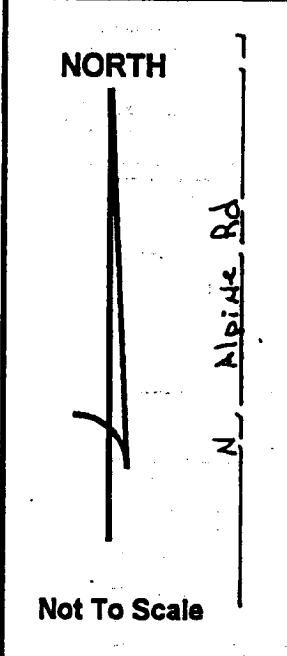
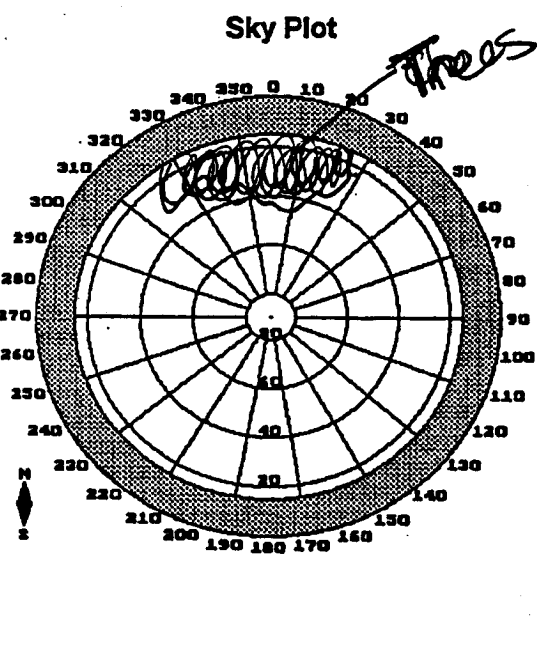
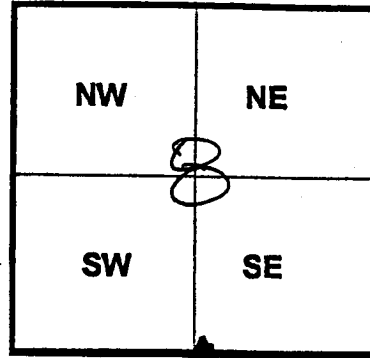

Not To Scale

Quad. Map _____
Photo No. _____

DESCRIPTION: Steel rod & Al Cap located NE 30' feet from N Alpine Rd & Spring Creek Rd; left South of South edge of bit on Spring Creek Rd. (BOL) 50ft North of church & driveway bit. Cap 0.1' above ground.