

**Winnebago County, IL  
GPS PROJECT 2000**

Station Name WIN 23.8N-12.1E A Station No. 1A

Section 1, Town 46 North, Range 02 (East) / West

Town of Roscoe, County Winnebago, State Illinois

Observer ELindaas; Date of observation 10/12/00

Order of Control 1<sup>ST</sup>  Meters  - Feet Zone: IL WEST

County Coordinates: N: 648259.288 LAT: 42 29 57.27155 N

H. Datum: NAD 83/91 E: 800540.339 LON: 88 56 36.54449 W

V. Datum: NAVD 88 ELEV: 258.430 ELLIP 224.750 GH '99 -33.68

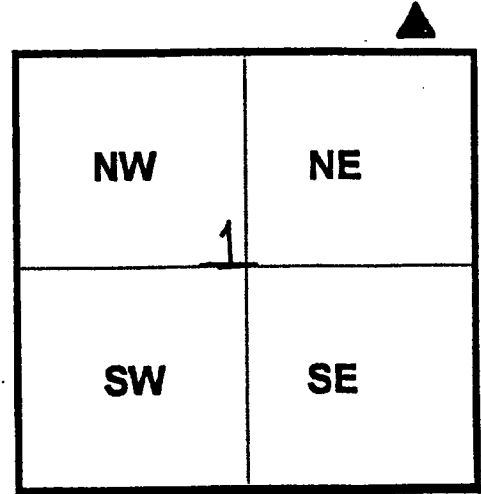

Sky Plot

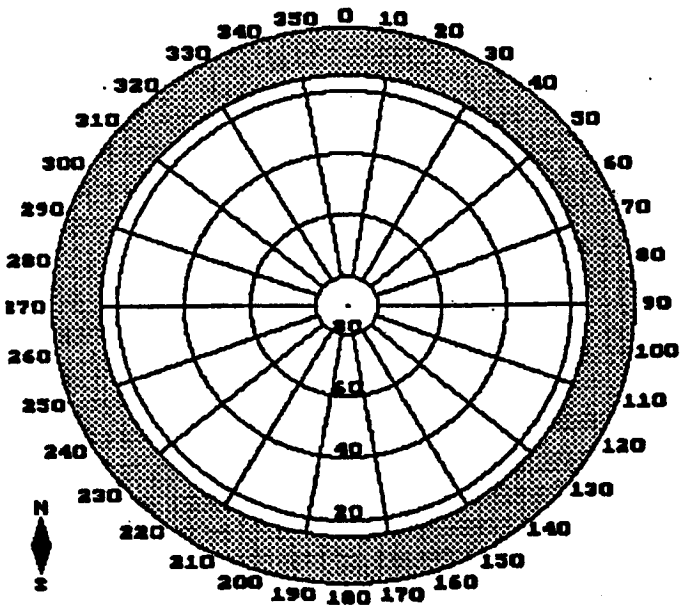

Clear

NORTH



Not To Scale

Sketch

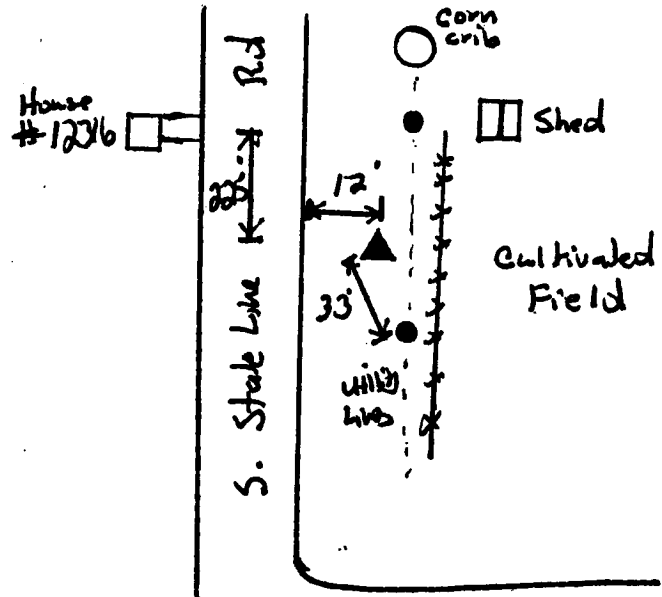

Quad. Map \_\_\_\_\_  
Photo No. \_\_\_\_\_

DESCRIPTION: Station is a stainless steel rod in PVC Pipe. Station is 33 feet North of Pop Power Pole "23 5E34 R 6" 225 feet South of P.S. 12316, 12 feet East of S. State Line Road and 1 foot West of an Orange carbonite witness post