

Winnebago County, IL
GPS PROJECT 2000

Station Name WIN 23.6N-11.5W A Station No. 121 A

Section 30, Town 29 North, Range 10 East West

Town of Ladoga, County Winnebago, State Illinois

Observer C. Trisoloff; Date of observation 21 Nov. 2000

Order of Control 1ST -Meters -Feet Zone: IL WEST

County Coordinates: N: 646274.851 LAT: 42 29 07.24282 N

H. Datum: NAD 83/91 E: 762968.187 LON: 89 24 02.72494 W

V. Datum: NAVD 88 ELEV: 252.840 ELLIP 219.290 GH '99 -33.55

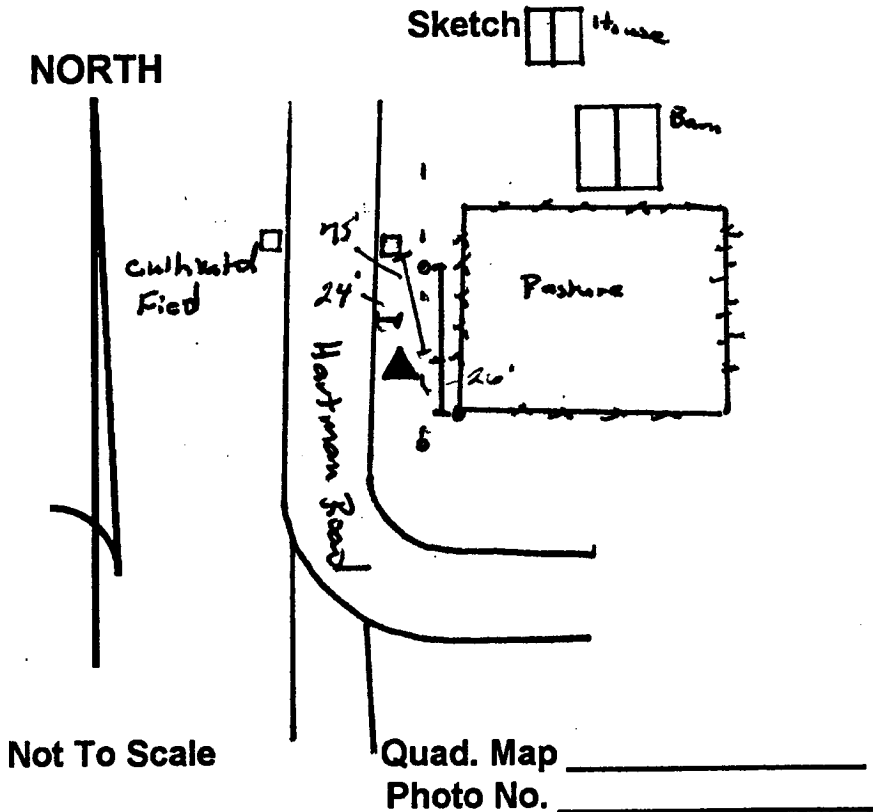
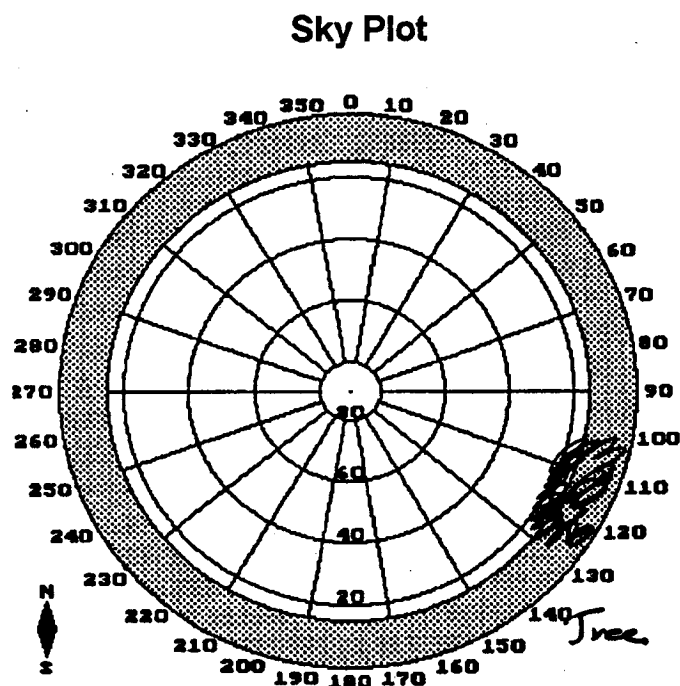
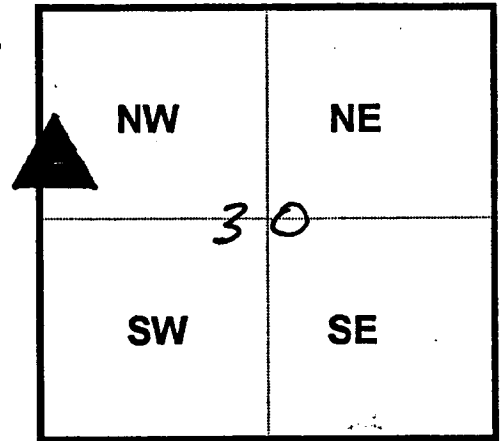

DESCRIPTION: Station is a stainless steel rod in PVC Pipe. Station is 24 feet East of the East EOP of Hedman Road, 26 feet Northwest of Southwest wood corner post to fence line of pasture, 75 feet South of the Southeast corner of a Concrete Box culvert and 2 feet West of an orange concrete witness post.
Note -- Station is 0.4 miles South of Walnut Grove Road.