

**Winnebago County, IL
GPS PROJECT 2000**

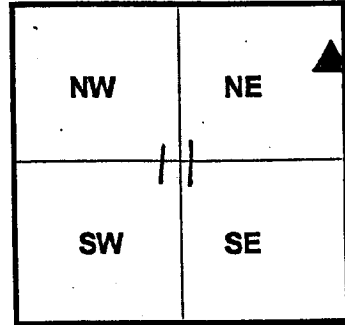

Station Name Win 16.9N-10.9E Station No. 12
 Section 11, Town 45 North, -Range 02 (East) West
 Town of Harlem, County Winnebago, State Illinois
 Observer E. Lindas; Date of observation 10/12/00
 Order of Control 1ST Meters - Feet Zone: IL WEST

County Coordinates: N: 636669.910 LAT: 42 23 42.34517 N
 H. Datum: NAD 83/91 E: 799233.948 LON: 88 57 40.95536 W
 V. Datum: NAVD 88 ELEV: 265.270 ELLIP 231.720 GH '99 -33.55

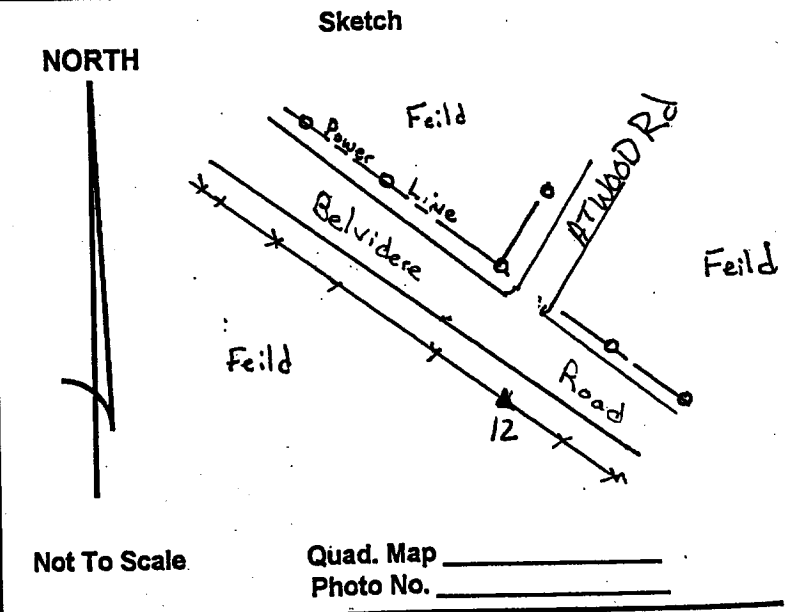
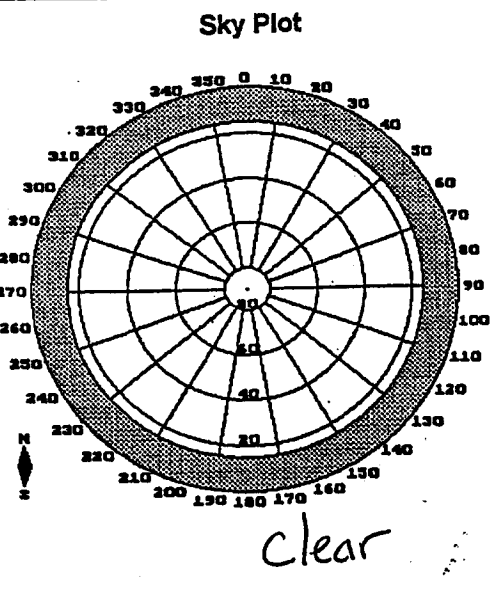

Quad. Map _____
 Photo No. _____

DESCRIPTION: All cap & Steel Rod Located 50'± South of & Atwood Rd & Belvidere Rd on fence line; 1 ft NW of Survey Marker, Cap at Ground level