

**Winnebago County, IL
GPS PROJECT 2000**

Station Name WIN 22.1N-09.7W Station No. 0115

Section 32, Town 29 North, -Range 10 East / West

Town of LAONA, County Winnebago, State Illinois

Observer D. MUEHLER; Date of observation 10.13.2000

Order of Control 1ST -Meters - Feet Zone: IL WEST

County Coordinates: N: 644376.316 LAT: 42 28 04.88969 N

H. Datum: NAD 83/91 E: 765734.286 LON: 89 22 02.39633 W

V. Datum: NAVD 88 ELEV: 267.750 ELLIP 234.210 GH '99 -33.54

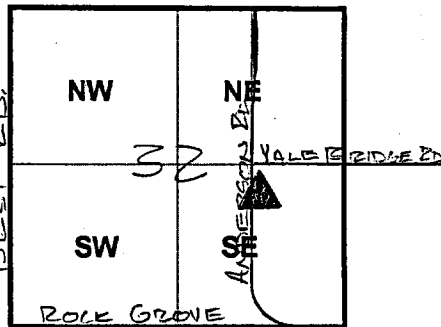

Sky Plot

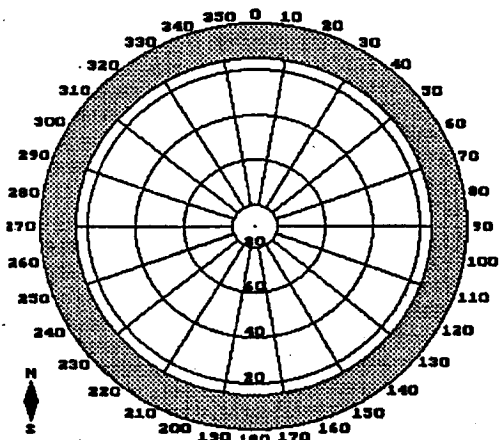

CLEAR

NORTH

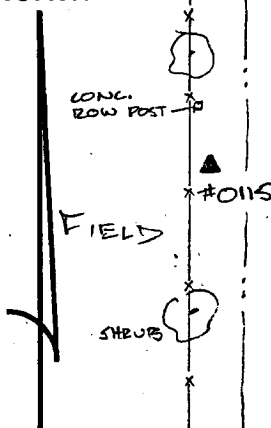

Not To Scale

Sketch

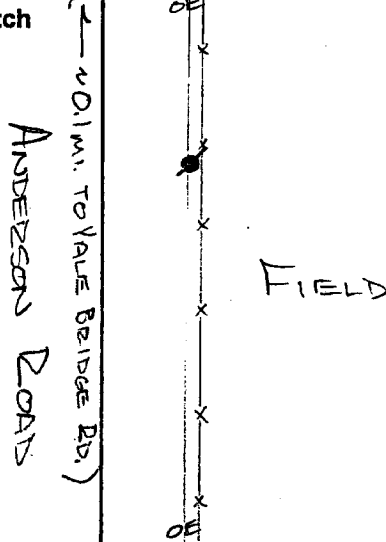

Quad. Map _____
Photo No. _____

DESCRIPTION: POINT 0115 IS A STAINLESS STEEL ROD IN A HAND-HOLE SET
0.25' BELOW GEL., LOCATED ~ 29' W/O & ANDERSON RD ~ 500' S/O
YALE BRIDGE ROAD, & ~ 7.0' SSE/O A CONC. ROW POST