

**Winnebago County, IL
GPS PROJECT 2000**

Station Name WIN 03.8N-07.3W Station No. 0114

Section 2, Town 25 North, Range 10 East / West

Town of LEAF RIVER, County Winnebago, State Illinois

Observer D. MUEHLH; Date of observation 10.20.2000

Order of Control 1ST -Meters - Feet Zone: IL WEST

County Coordinates: N: 614924.568 LAT: 42 12 09.00897 N
 E: 770246.588 LON: 89 18 57.77530 W
 H. Datum: NAD 83/97 ELEV: 258.950 GH '99 -33.10
 V. Datum: NAVD 88 ELLIP

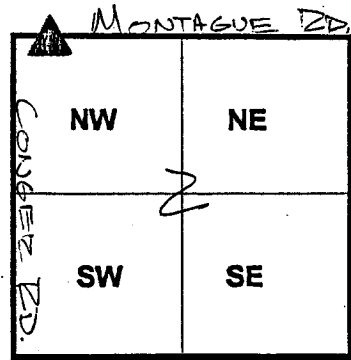

Sky Plot

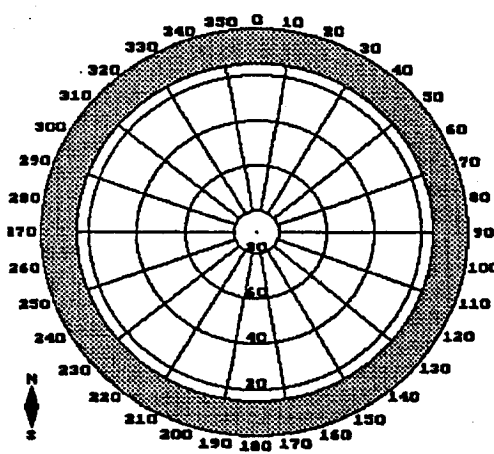

CLEAR

Sketch

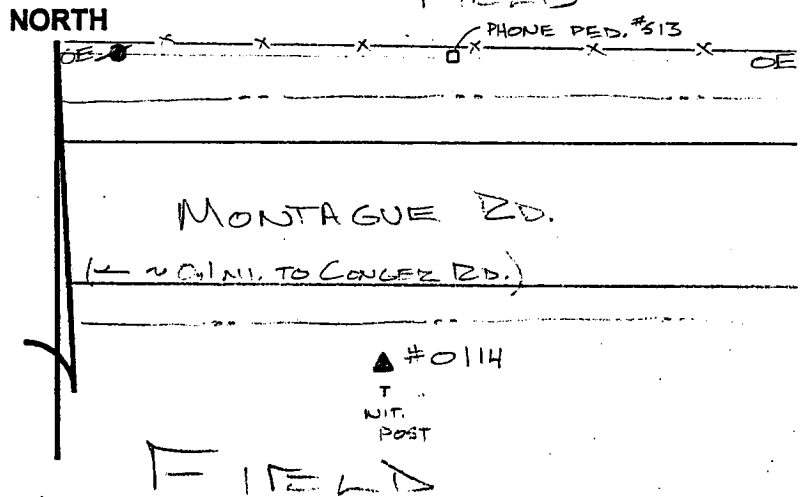

Not To Scale

Quad. Map _____
Photo No. _____

DESCRIPTION: POINT 0114 IS A STAINLESS STEEL ROD SET 0.1' BELOW GROUND IN A HAND-HOLE, LOCATED ~37' S/O & MONTAGUE RD. ~0.1 MI E/O CONGER RD. SOUTH, 1.0' N/O A WITNESS POST, ~135' WSW/O A "PASS W/ CARE" SIGN.