

**Winnebago County, IL  
GPS PROJECT 2000**

Station Name WIN 7.8N-08.0W Station No. 112

Section 15, Town 26 North, Range 10 (East) / West

Town of Seward, County Winnebago, State Illinois

Observer E. Lindas; Date of observation 10/19/00

Order of Control 1<sup>ST</sup>  -Meters  - Feet Zone: IL WEST

County Coordinates: N: 621351.483 LAT: 42 15 37.67308 N

H. Datum: NAD 83/97 E: 769062.226 LON: 89 19 46.64830 W

V. Datum: NAVD 88 ELEV: 249.400 ELLIP: 216.190 GH '99 -33.21

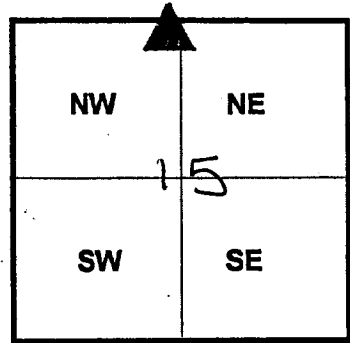

Sky Plot

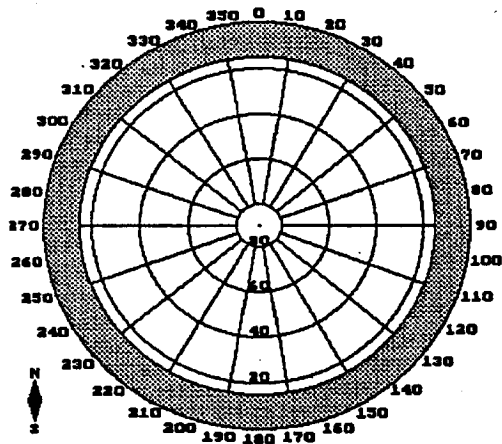

clear

Sketch

NORTH

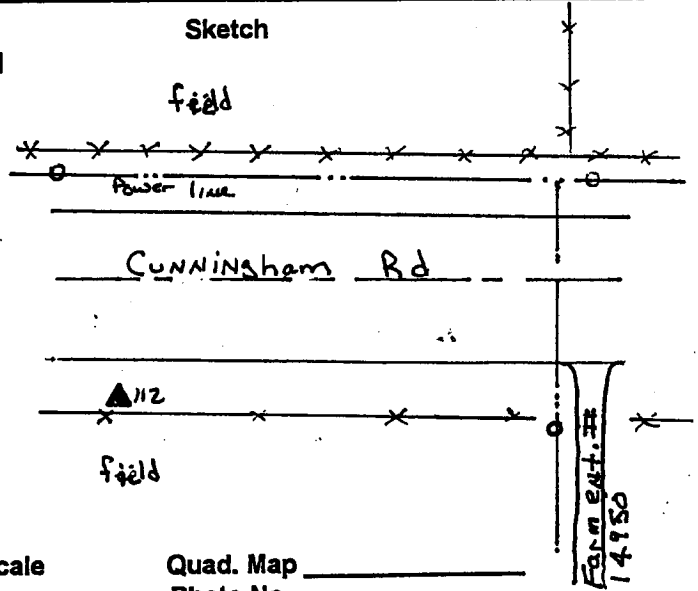

Not To Scale

Quad. Map \_\_\_\_\_  
Photo No. \_\_\_\_\_

DESCRIPTION: <sup>west</sup> Steel rod & Al cap located 0.53 mile from Conger Rd & Cunningham Rd; 1/49 mile East from Pecatonica Rd & Cunningham Rd; 255 ft West of P.E. # 14950; 15ft North of fence line; 26 ft South of South edge of bit-cap at ground level.