

**Winnebago County, IL
GPS PROJECT 2000**

Station Name WIN 15.7N-07.7W Station No. 0110

Section 34, Town 28 North, Range 10 East / West

Town of DUZAND, County Winnebago, State Illinois

Observer D. MUENCHA; Date of observation 10-16-2000

Order of Control 1ST -Meters - Feet Zone: IL WEST

County Coordinates: N: 634139.291 LAT: 42 22 32.02251 N

H. Datum: NAD 83/91 E: 769292.048 LON: 89 19 31.10570 W

V. Datum: NAVD 88 ELEV: 268.710 ELLIP 235.300 GH '99 -33.41

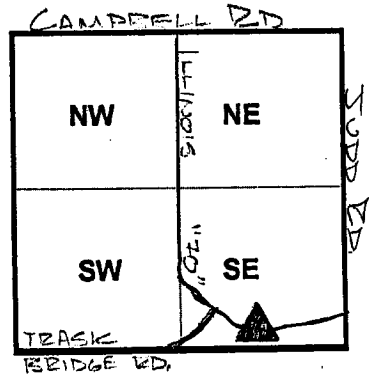

Sky Plot

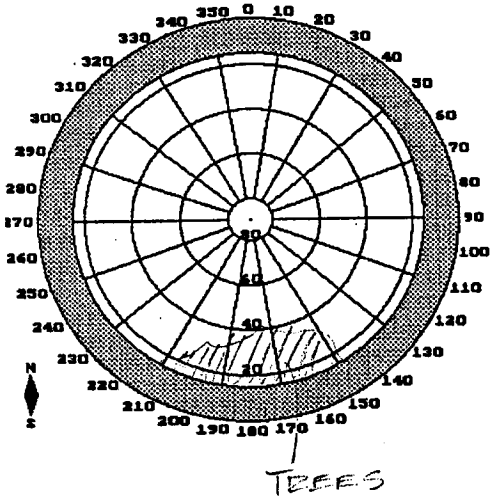

Sketch

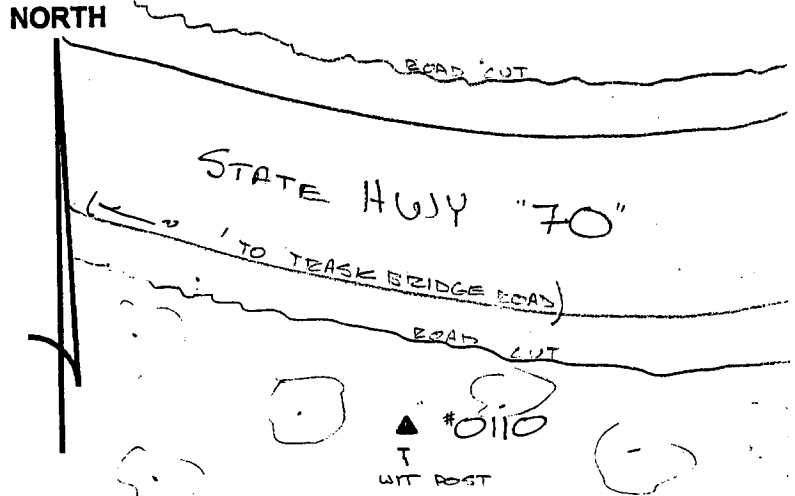

Not To Scale

Quad. Map _____

Photo No. _____

DESCRIPTION: POINT #0110 IS A STAINLESS STEEL ROD SET 0.45' ABOVE GROUND IN A PVC HAND-HOLE LOCATED ~65' S/O STATE HIGHWAY "70" ~1000' E/O TRASK BRIDGE ROAD. ~1.0' N/O A CARBONITE WITNESS POST