

**Winnebago County, IL  
GPS PROJECT 2000**

Station Name WIN 17.4N-7.9W Station No. 0109

Section 27, Town 28 North, -Range 10 (East) West

Town of DUZAND, County Winnebago, State Illinois

Observer D. MUENCH; Date of observation 10.13.2000

Order of Control 1<sup>ST</sup>  -Meters  - Feet Zone: IL WEST

County Coordinates: N: 636873.031 LAT: 42 24 00.76019 N

H. Datum: NAD 83/91 E: 768839.778 LON: 89 19 49.69762 W

V. Datum: NAVD 88 ELEV: 272.740 ELLIP 239.300 GH '99 -33.44

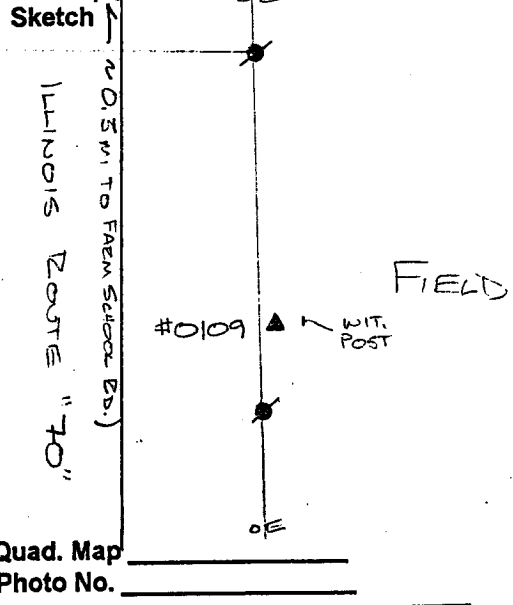
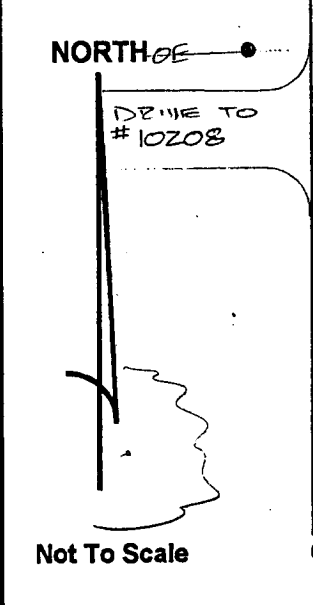
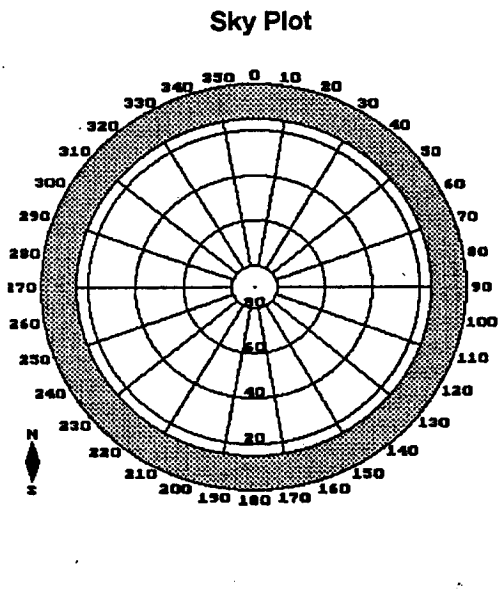
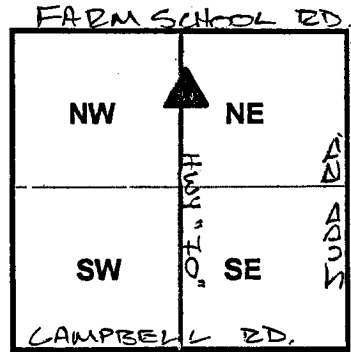

**DESCRIPTION:** POINT 0109 IS A STAINLESS STEEL ROD IN A PVC HAND-HOLE SET 0.1' BELOW GROUND, LOCATED ~ 60' E/O ILLINOIS HIGHWAY "70" ~ 0.3 MI S/O FARM SCHOOL RD.