

**Winnebago County, IL  
GPS PROJECT 2000**

Station Name WIN 14.8N-01.0E Station No. 80

Section 20, Town 45 North, Range 1 East West

Town of Owen, County Winnebago, State Illinois

Observer E. Lindas; Date of observation 10/17/00

Order of Control 1<sup>ST</sup>  -Meters  -Feet Zone: IL WEST

County Coordinates: N: 632917.382 LAT: 42 21 47.49836 N

H. Datum: NAD 83/91 E: 783247.968 LON: 89 09 21.78372 W

V. Datum: NAVD 88 ELEV: 267.310 ELLIP: 233.860 GH '99 -33.45

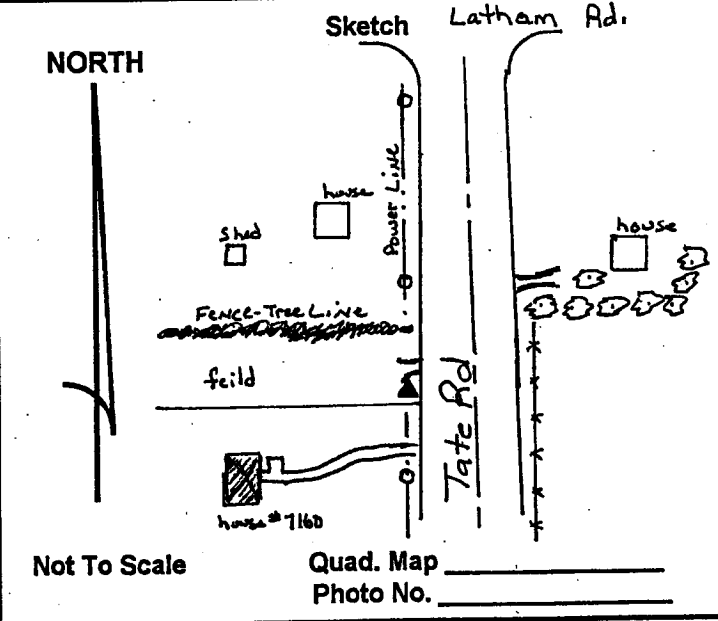
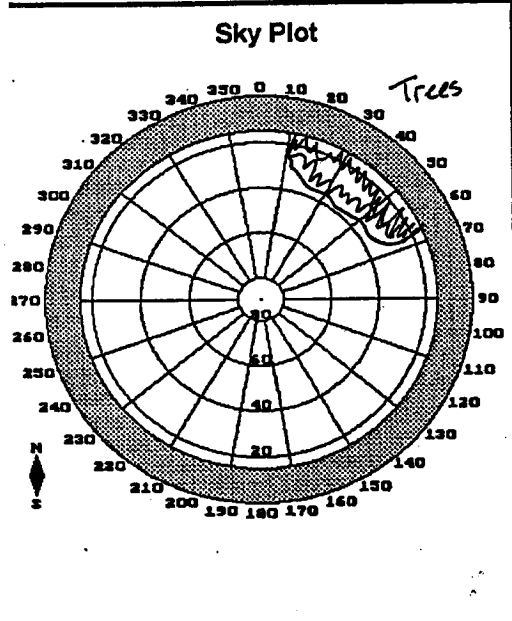
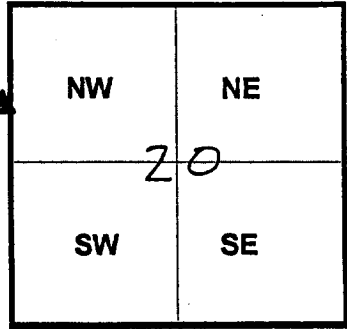

DESCRIPTION: All Cap & Steel Rod Located 0.31 mile South of Tate Rd & Latham Rd inters;  
40' ± North of PE # 7160; 20' ± South of field enter; 17' West of West edge of bit;  
1' East of orange witness post; Cap at ground level.