

**Winnebago County, IL  
GPS PROJECT 2000**

Station Name WIN 17.8N-01.5W Station No. 78

Section 23, Town 28 North, Range 11 East West

Town of Harrison, County Winnebago, State Illinois

Observer E. Lindaas; Date of observation 13 Oct. 2000

Order of Control 1<sup>ST</sup>  -Meters  -Feet Zone: IL WEST

County Coordinates: N: 637660.096 LAT: 42 24 22.70140 N

H. Datum: NAD 83/91 E: 779231.544 LON: 89 12 14.94319 W

V. Datum: NAVD 88 ELEV: 223.940 ELLIP: 190.430 GH '99 -33.51

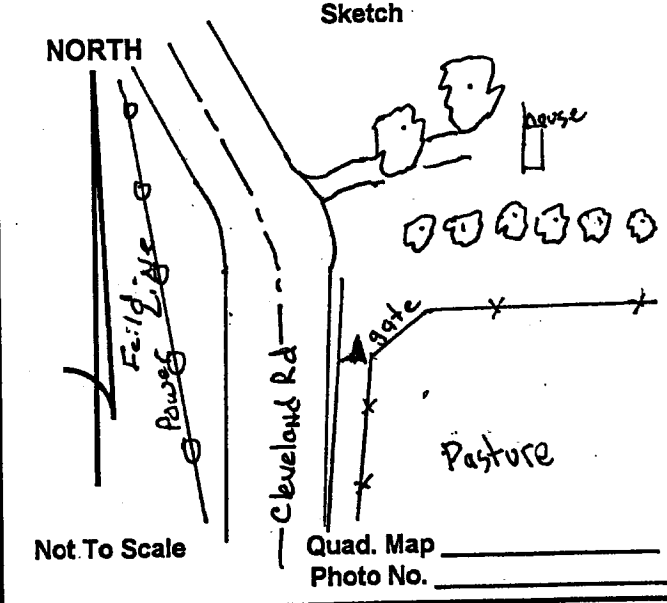
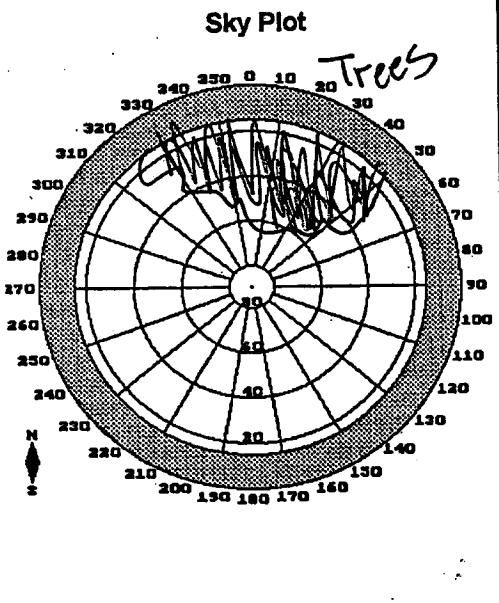
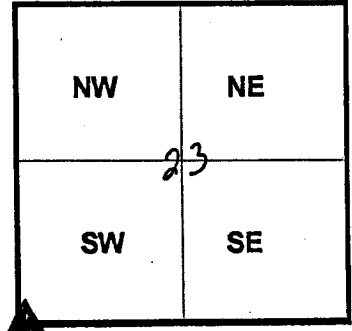

DESCRIPTION: Steel Rod & Al Cap located 1.25 mile South of E Cleveland Rd  
Freeport Rd: 150'± South of P.E #; 4' East of East edge of Cleveland Rd.  
bit; 1'± West of fence corner. Cap 0.2' above ground level.