

**Winnebago County, IL
GPS PROJECT 2000**

Station Name WIN 02.0N-04.2E Station No. 0059

Section 26, Town 43 North, Range 1 East West

Town of SW ROCKFORD, County Winnebago, State Illinois

Observer D. MUEENCH; Date of observation 10.24.2000

Order of Control 1ST -Meters - Feet Zone: IL WEST

County Coordinates: N: 612433.278 LAT: 42 10 41.47487 N

H. Datum: NAD 83/91 E: 788830.249 LON: 89 05 29.15945 W

V. Datum: NAVD 88 ELEV: 212.510 ELLIP: 179.330 GH '99 -33.18

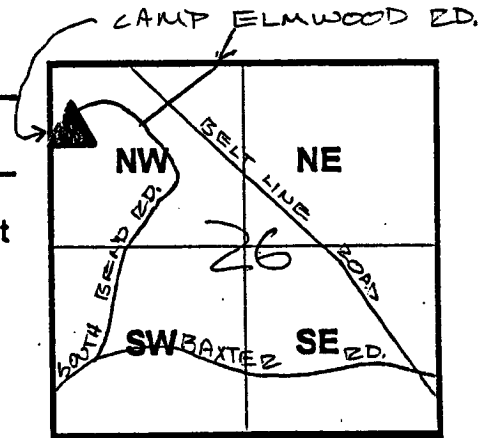

Sky Plot

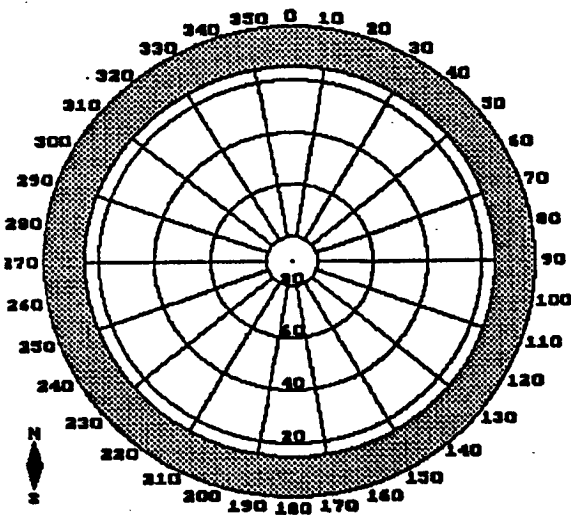

Sketch

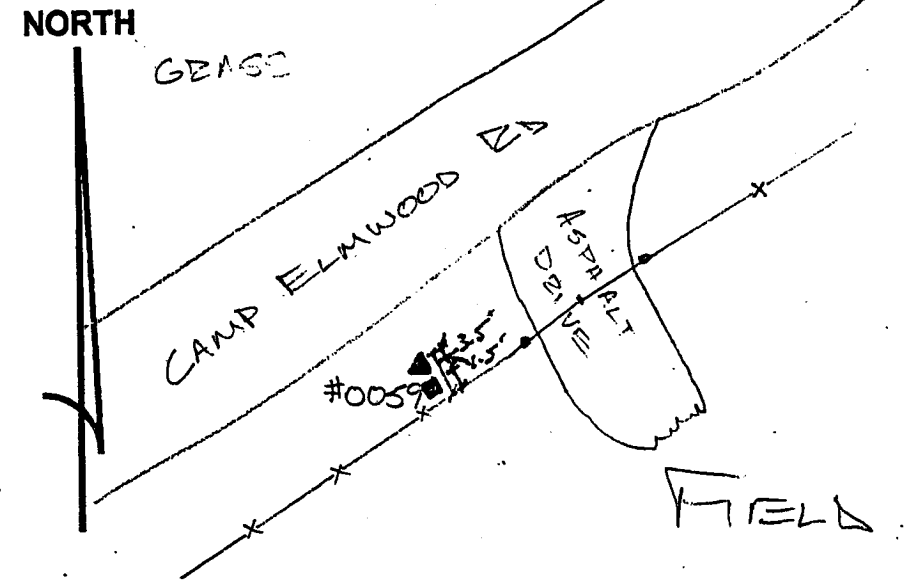

Not To Scale

Quad. Map _____
Photo No. _____

DESCRIPTION: POINT 0059 IS A STAINLESS STEEL ROD IN A PVC HAND-HOLE SET 0.1' BELOW GROUND ~ 26' SE/O CAMP ELMWOOD RD. ~ 28' SW/O THE CENTER OF A GATE ON A PAVED ENT. TO A FIELD, ~ 3' NW/O A FENCE LINE & LARSONITE WIT. POST. SEE NOTES