

**Winnebago County, IL  
GPS PROJECT 2000**

Station Name WIN 17.1N-05.9E Station No. 0039

Section 6, Town 45-, North, -Range 2 (East) West

Town of ROSCOE, County Winnebago, State Illinois

Observer D. MUEHLH; Date of observation 10.12.2000

Order of Control 1<sup>ST</sup>  -Meters  - Feet Zone: IL WEST

County Coordinates: N: 636858.582 LAT: 42 23 52.0117 N

H. Datum: NAD 83/91 E: 791179.562 LON: 89 03 32.96243 W

V. Datum: NAVD 88 ELEV: 244.880 ELLIP 211.340 GH '99 -33.54

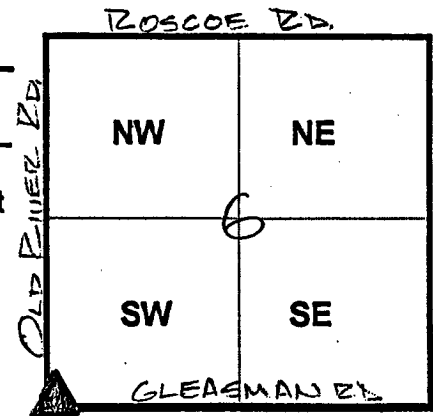

Sky Plot

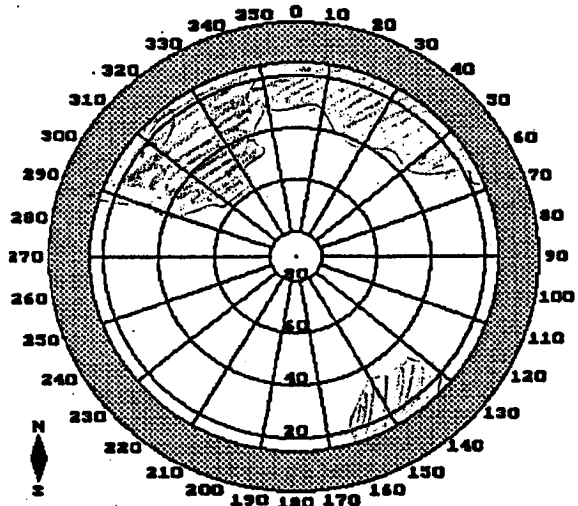

TREES

NORTH

FIELD

Not To Scale

Sketch

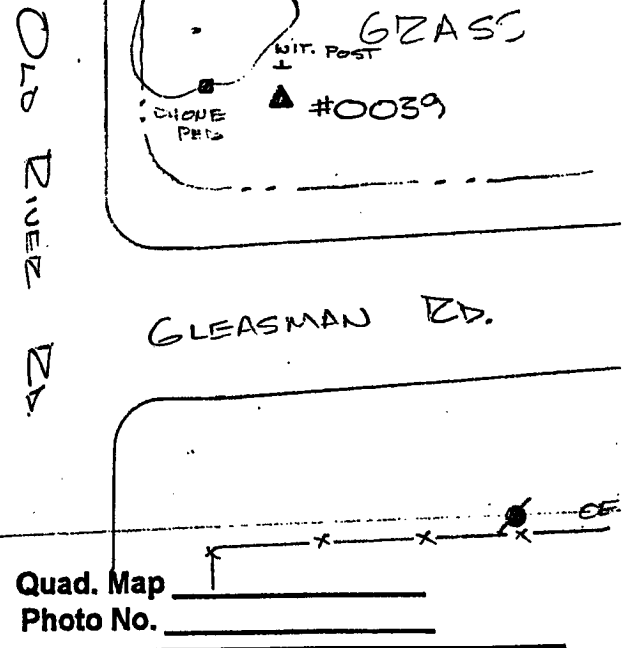

DESCRIPTION: POINT 0039 IS A STAINLESS STEEL ROD SET 0.05' BLW. GRD. IN A HAND-HOLE, LOCATED ~50' N/0° (GLEASMAN RD.), ~60' E/O OLD RIVER ROAD, ~18' ESE/O A PHONE PED (1500/23), & ~1.0' S/O A CARBONITE WITNESS POST.