

Winnebago County, IL
GPS PROJECT 2000

Station Name WIN 04.7N-09.6E Station No. 0016

Section 10, Town 43 North, Range 2 (East) West

Town of Cherry Valley, County Winnebago, State Illinois

Observer C. Trieloff; Date of observation 25 Oct. 2000

Order of Control 1ST -Meters - Feet Zone: IL WEST

County Coordinates: N: 616885.079 LAT: 42 13 02.07002 N

H. Datum: NAD 83/97 E: 797392.731 LON: 88 59 13.43398 W

V. Datum: NAVD 88 ELEV: 243.020 ELLIP 209.740 GH '99 -33.28

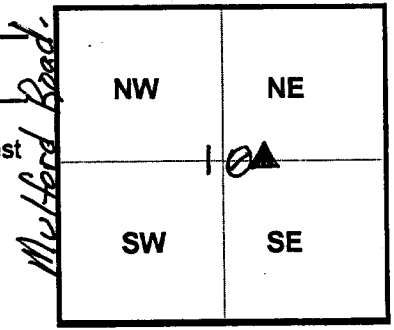

Sky Plot

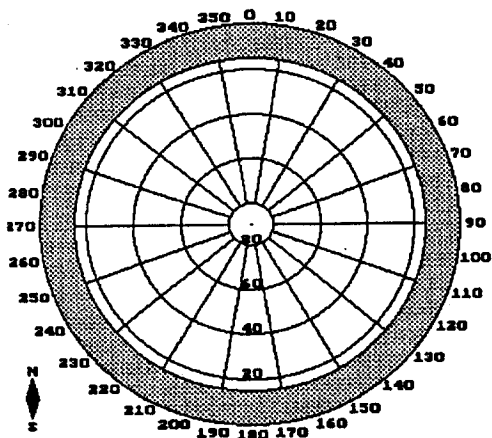

Clear

Sketch

NORTH

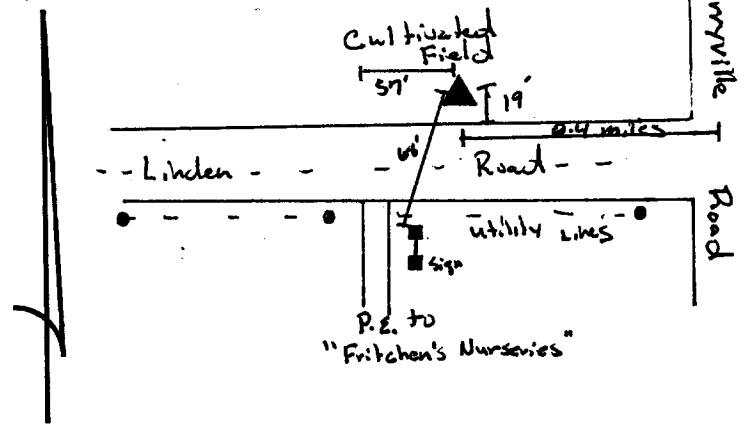

Not To Scale

Quad. Map _____

Photo No. _____

DESCRIPTION: Station is a stainless steel rod in PVC Pipe. Station is 57 feet East of Ext. 4 of P.E. to "Fritchens Nurseries" (Gravel Drive), 0.4 miles West of Perryville Road, 19 feet North of the North EOP of Linden Road, and 0.4 feet South of an Orange Corsonite Witness post, and 68 feet NE of the Northern most wood post to "Fritchens Nurseries" Sign.