

**Winnebago County, IL
GPS PROJECT 2000**

Station Name WIN 05.3N 04.9W Station No. 105

Section 30, Town ~~E~~ 26 North, Range 11 East ~~West~~

Town of WINNEBAGO, County Winnebago, State Illinois

Observer C SANDSUGS; Date of observation 20 OCT 2000

Order of Control 1ST -Meters - Feet Zone: IL WEST

County Coordinates: N: 617439.766 LAT: 42 13 29.26714 N

H. Datum: NAD 83/91 E: 774023.880 LON: 89 16 11.97985 W

V. Datum: NAVD 88 ELEV: 271.980 ELLIP 238.810 GH '99 -33.17

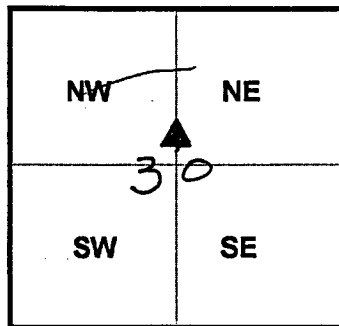

Sky Plot

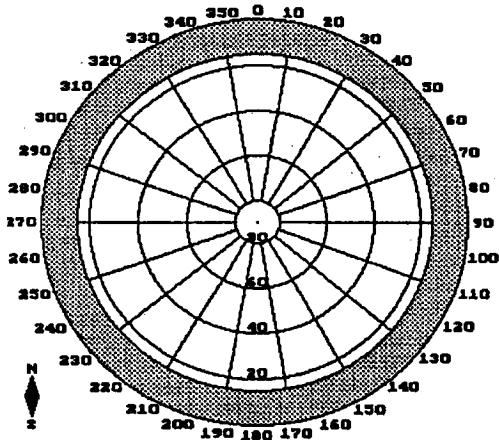

CLEAR

NORTH



Not To Scale

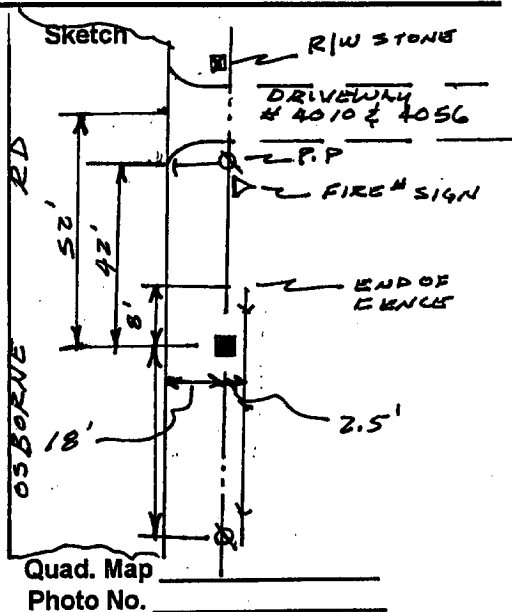

DESCRIPTION: SET STEEL ROD IN ACCESS BOX 0.51 MILES SOUTH OF EDWARDSVILLE RD (HWY 4) ALONG OSBORNE RD; STATION IS 18 FEET EAST OF EAST EDGE OF PAVEMENT & 52 FEET SOUTH OF CENTER LINE OF DRIVEWAY # 4010, 4056; 8 FEET SOUTH OF NORTH END OF FENCE LINE & 2.5 FEET WEST OF FENCE