

**Winnebago County, IL
GPS PROJECT 2000**

Station Name WIN ~~04.7~~^{4.7}N-12.2E A Station No. 7A

Section 7, Town 43 North, Range 3 East / West

Town of Flora, County Boone Winnebago, State Illinois

Observer E. Lindas; Date of observation 28 Oct. 2000

Order of Control 1ST -Meters -Feet Zone: IL WEST

County Coordinates: N: 617586.236 LAT: 42 13 22.25357 N

H. Datum: NAD 83/91 E: 802895.381 LON: 88 55 13.11140 W

V. Datum: NAVD 88 ELEV: 179.600 ELLIP: 146.280 GH '99 -33.32

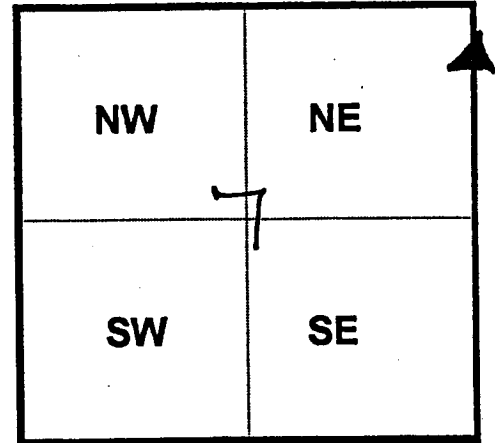

Sky Plot

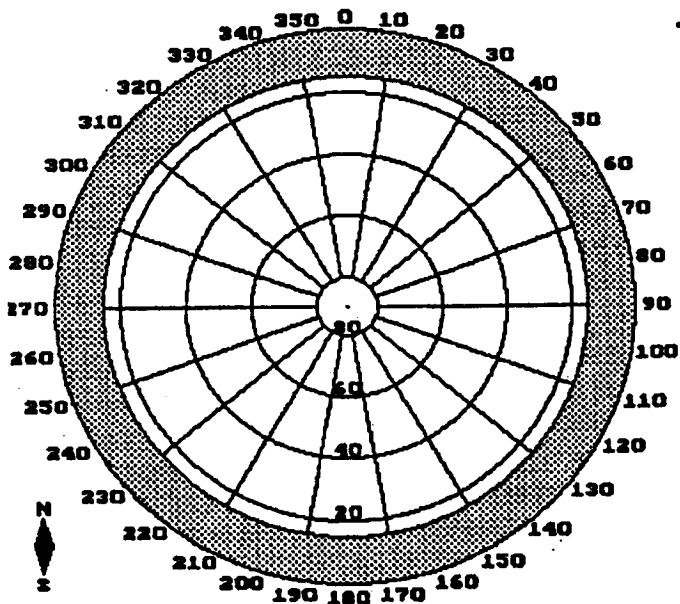

Clear

Sketch

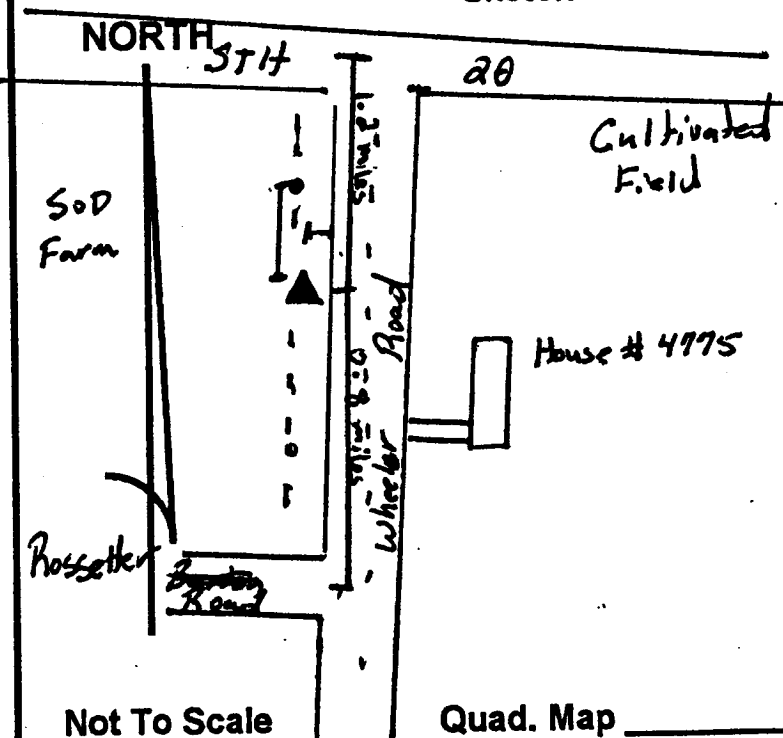

Quad. Map _____
Photo No. _____

DESCRIPTION: Station is a stainless steel rod in PVC Pipe. Station is 0.8 miles North of Burton Road, 14 feet West of the West EOP of Wheeler Road, 65 feet South of utility pole "PR30 35" and 1 foot East of an orange carside witness pole