

**Winnebago County, IL  
GPS PROJECT 2000**

Station Name WIN 07.2N 01.0E Station No. 67

Section 30, Town 44 North, Range 1 East / ~~West~~

Town of ROCKFORD, County Winnebago, State Illinois

Observer C. SANDNES; Date of observation 20 OCT 2000

Order of Control 1<sup>ST</sup>  -Meters  -Feet Zone: IL WEST

County Coordinates: N: 620692.667 LAT: 42 15 11.26223 N

H. Datum: NAD 83/91 E: 783456.680 LON: 89 09 19.01144 W

V. Datum: NAVD 88 ELEV: 254.360 ELLIP 221.090 GH '99 -33.27

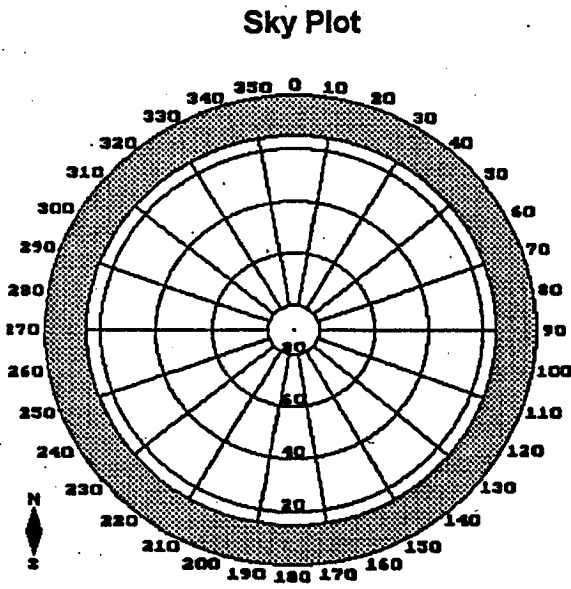
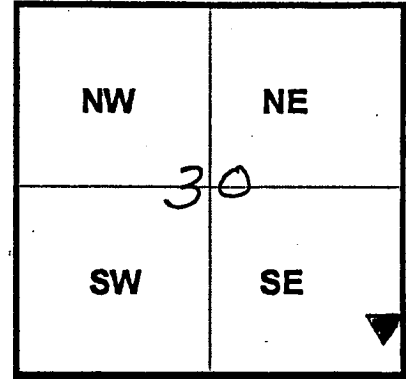

CLEAR

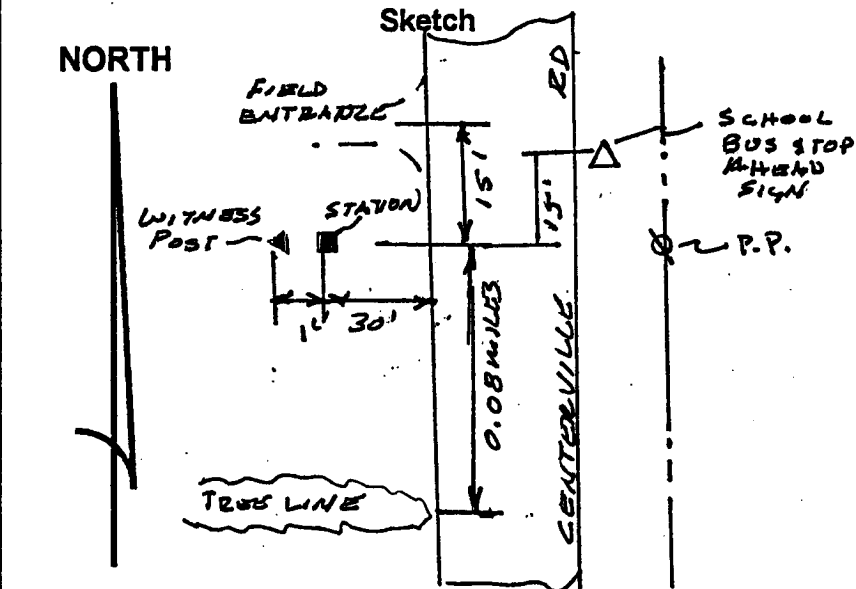

Not To Scale

Quad. Map \_\_\_\_\_  
Photo No. \_\_\_\_\_

DESCRIPTION: SET STEEL ROD IN ALLEYS BOX 0.41 MILES SOUTH OF  
CUNNINGHAM ROAD ALONG CENTERVILLE ROAD, STATION IS  
30 FEET WEST OF WEST EDGE OF PAVEMENT & 15 FEET SOUTH  
OF CENTER LINE OF FIELD ENTRANCE.