

**Winnebago County, IL
GPS PROJECT 2000**

Station Name WIN 12.3N-04.0E Station No. 0055

Section 34, Town 45 North, Range 1 East West

Town of OWEN, County Winnebago, State Illinois

Observer D. M. UENCH; Date of observation 10-16-2000

Order of Control 1ST -Meters - Feet Zone: IL WEST

County Coordinates: N: 629065.079 LAT: 42 19 40.73385 N

H. Datum: NAD 83/91 E: 788114.573 LON: 89 05 51.24763 W

V. Datum: NAVD 88 ELEV: 235.470 ELLIP 202.060 GH '99 -33.41

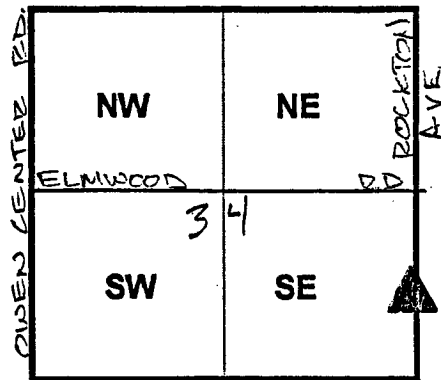

Sky Plot

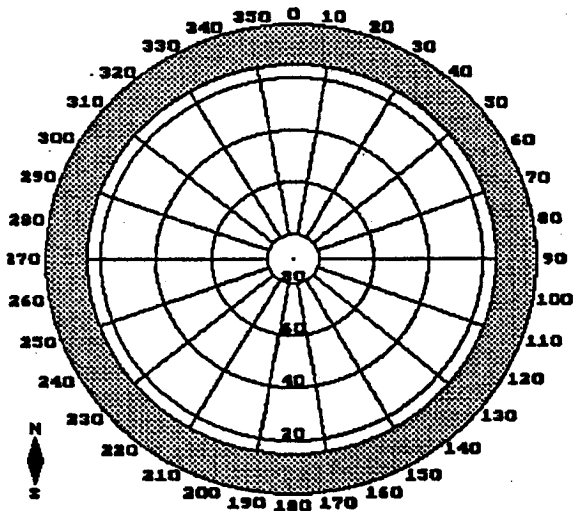

Sketch

NORTH

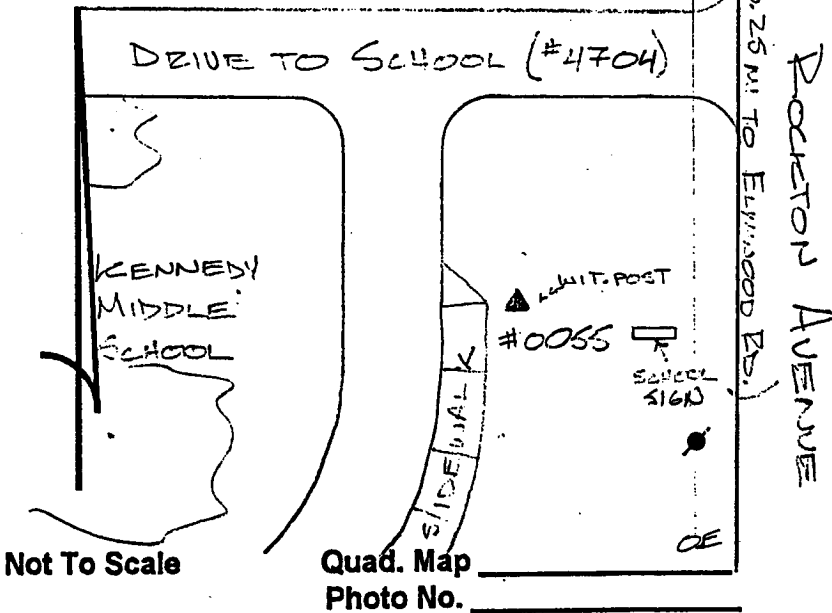

Not To Scale

Quad. Map
Photo No.

DESCRIPTION: POINT 0055 IS A STAINLESS STEEL ROD SET 0.05' BELOW GROUND, IN A HAND HOLE LOCATED ON THE GROUNDS OF KENNEDY MIDDLE SCHOOL, 4704 N. ROCKTON AVE. THE POINT IS 2121' W/O & ROCKTON AVE, 295' S/O & OF THE ENTRANCE TO THE SCHOOL, 262' ENE/O THE SCHOOL'S SIGN, & 21.0' W/O A CARBONITE WITNESS POST.