

Station No. _____

**Winnebago County, IL
GPS PROJECT 2000**

Station Name WIN 13.6-06.4E Station No. 41

Section 30 Town 45 North-Range 2 ~~East~~ West

Town of Harlem County Winnebago State Illinois

Observer C. Sandness ; Date of observation 10/17/2000

Order of Control 1ST -Meters - Feet Zone: IL WEST

County Coordinates: N: 631202.459 LAT: 42 20 48.36459 N

H. Datum: NAD 83/91 E: 792032.246 LON: 89 02 58.93299 W

V. Datum: NAVD 88 ELEV: 224.000 ELLIP 190.540 GH '99 -33.46

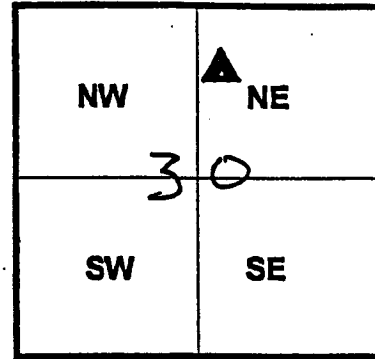

Sky Plot

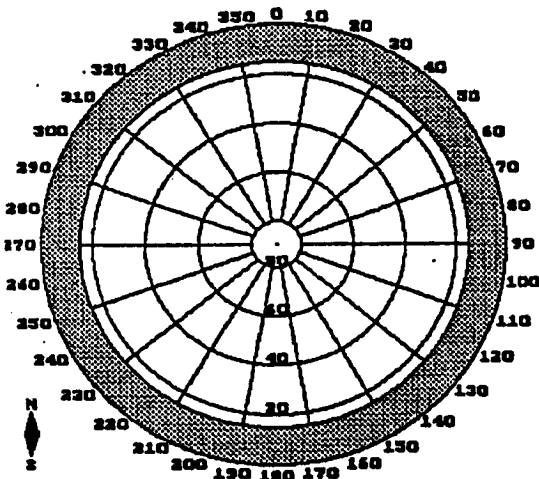

CLEAR

Sketch

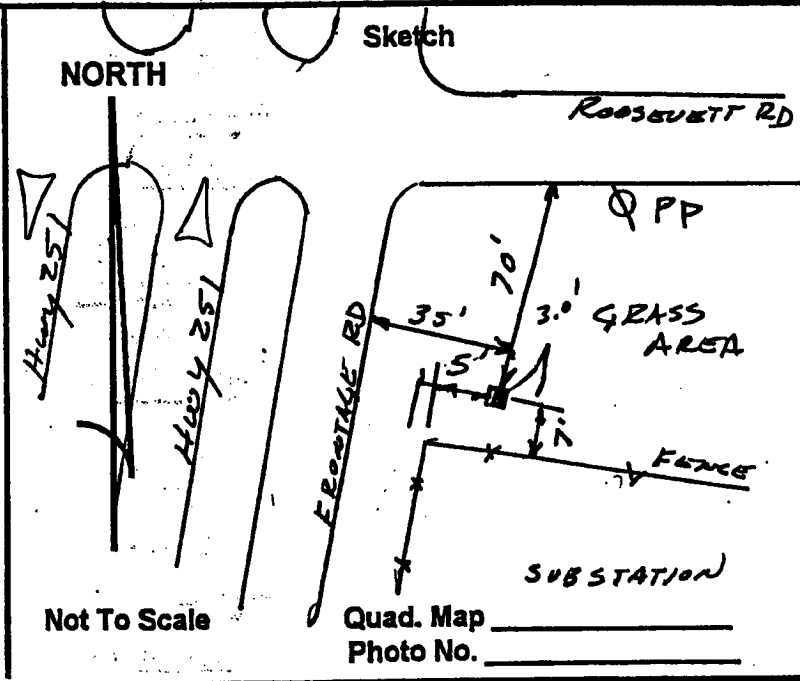

Not To Scale

Quad. Map _____
Photo No. _____

DESCRIPTION: Station is a stainless steel rod in a PVC pipe,
70 ft South of Roosevelt Rd; 35' East of Frontage Road; 7' North
of chain link fence,