

**Winnebago County, IL
GPS PROJECT 2000**

Station Name WIN 15.2N-12.0E Station No. 0004

Section 13, Town 45 North, Range 2 East West

Town of Harlem, County Winnebago, State Illinois

Observer C. Trieloff; Date of observation 17 October 2000

Order of Control 1ST Meters Feet Zone: IL WEST

County Coordinates: N: 633940.956 LAT: 42 22 13.13117 N

H. Datum: NAD 83/91 E: 800931.127 LON: 88 56 28.48206 W

V. Datum: NAVD 88 ELEV: 279.080 ELLIP 245.560 GH '99 -33.52

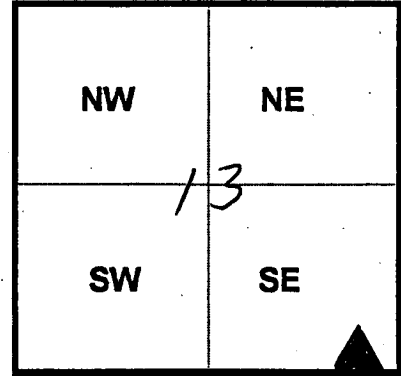

Sky Plot

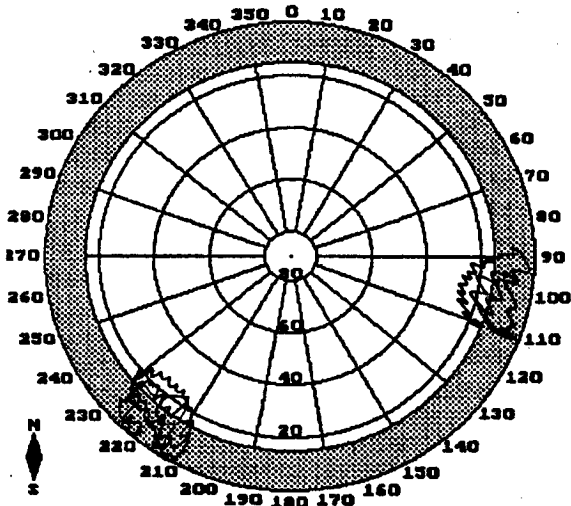

Sketch

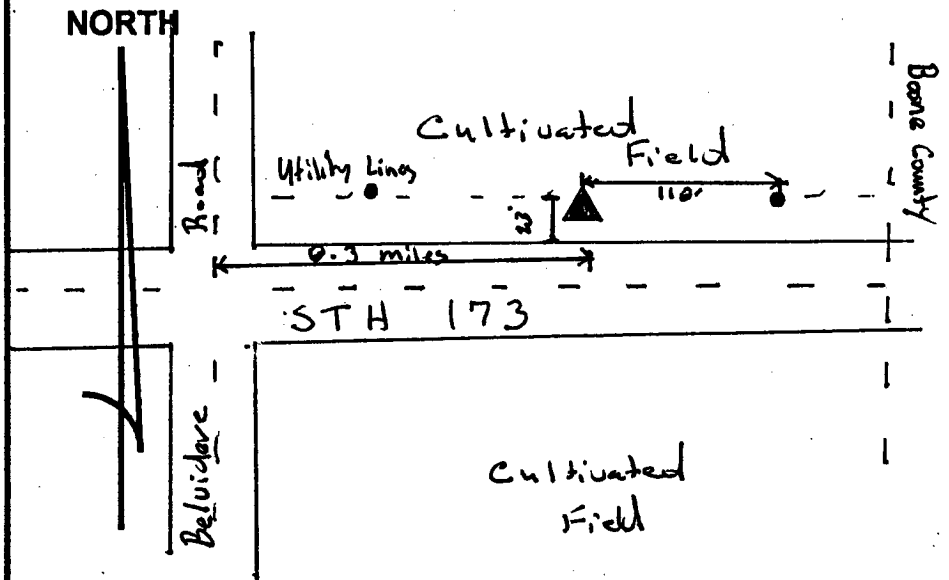

Not To Scale

Quad. Map _____
Photo No. _____

DESCRIPTION: Station is a Steel Rod in PVC Pipe. Station is 0.3 miles East of Belvidere Road, 23 feet North of the North EOP of State Highway 173, 110 feet West of Utility Pole, and 1 foot South of an orange Corsonite witness pole.