

**Winnebago County, IL
GPS PROJECT 2000**

Station Name WIN 06.3N-10.3E Station No. 0025

Section 35, Town 44 North, -Range 2 East / West

Town of NE ZOCKFORD, County Winnebago, State Illinois

Observer D. MUEHLH; Date of observation 10.25.2000

Order of Control 1ST -Meters - Feet Zone: IL WEST

County Coordinates: N: 619574.536 LAT: 42 14 28.73681 N

H. Datum: NAD 83/97 E: 798466.377 LON: 88 58 24.98908 W

V. Datum: NAVD 88 ELEV: 235.750 ELLIP 202.420 GH '99 -33.33

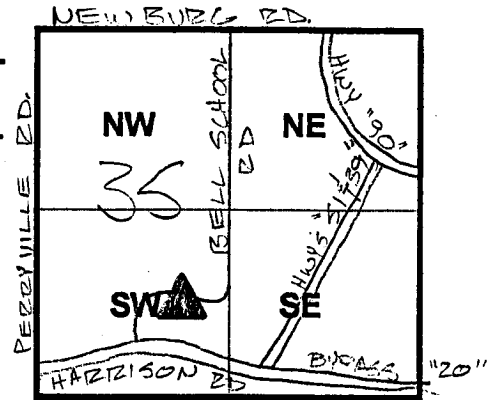

Sky Plot

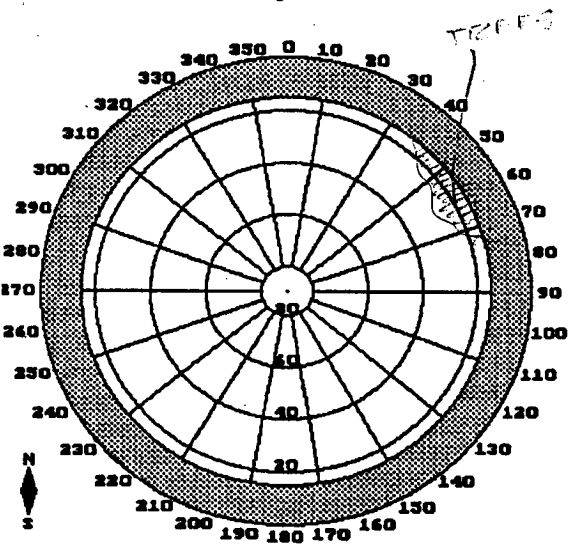

Sketch

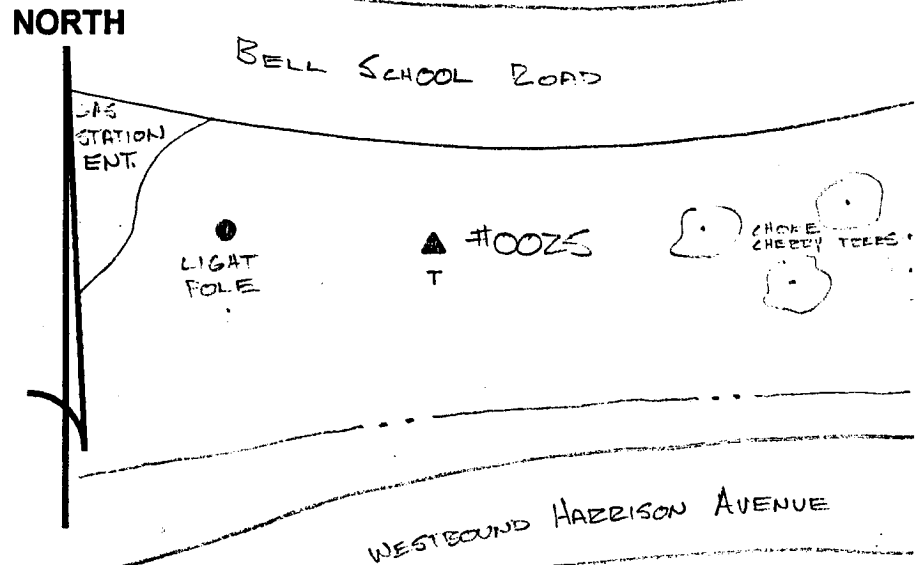

Not To Scale

Quad. Map _____
Photo No. _____

DESCRIPTION: POINT 0025 IS A STAINLESS STEEL ROD SET 0.15' BELOW GROUND IN A DUG HAND-HOLE, LOCATED ~27' S/O & BELL SCHOOL ROAD, ~80' N/O & WESTBOUND HARRISON RD, ~28' E/O A LIGHTPOLE, & 1.0' N/O A CARBONITE WITNESS POST.