

**Winnebago County, IL
GPS PROJECT 2000**

Station Name WIN 8.7N-09.4W A Station No. 119A

Section 8, Town 26 North, -Range 10 East West

Town of Seward, County Winnebago, State Illinois

Observer C. Trieloff; Date of observation 16 Nov. 2000

Order of Control 1ST -Meters - Feet Zone: IL WEST

County Coordinates: N: 622462.049 LAT: 42 16 14.42021 N

H. Datum: NAD 83/91 E: 766646.790 LON: 89 21 31.56976 W

V. Datum: NAVD 88 ELEV: 259.400 ELLIP 226.170 GH '99 -33.23

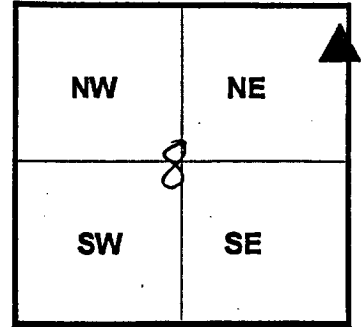

Sky Plot

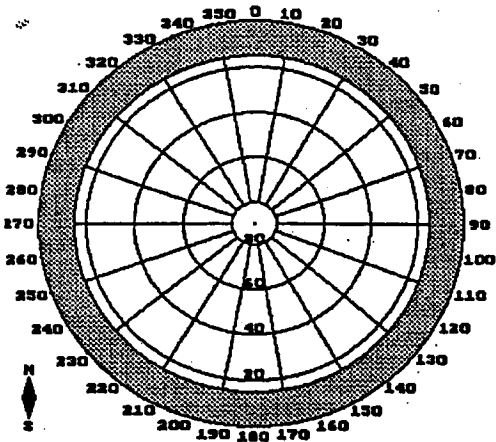

Sketch

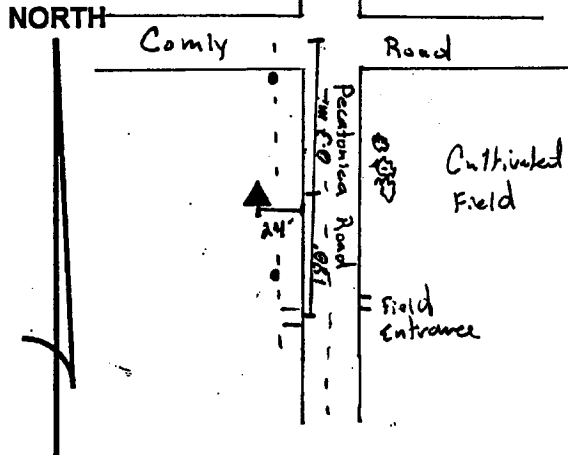

Not To Scale

Quad. Map _____
Photo No. _____

DESCRIPTION: Station is a stainless steel rod in PK Ppr. Station is
0.3 miles south of Comly Road, 180 feet north of the western most
Field Entrance, 24 feet west of the West EOP of Pecatonica
Road, and 1 foot East of an orange concrete witness post.